

solids Rotary Valve
Type SRVP-Protective System

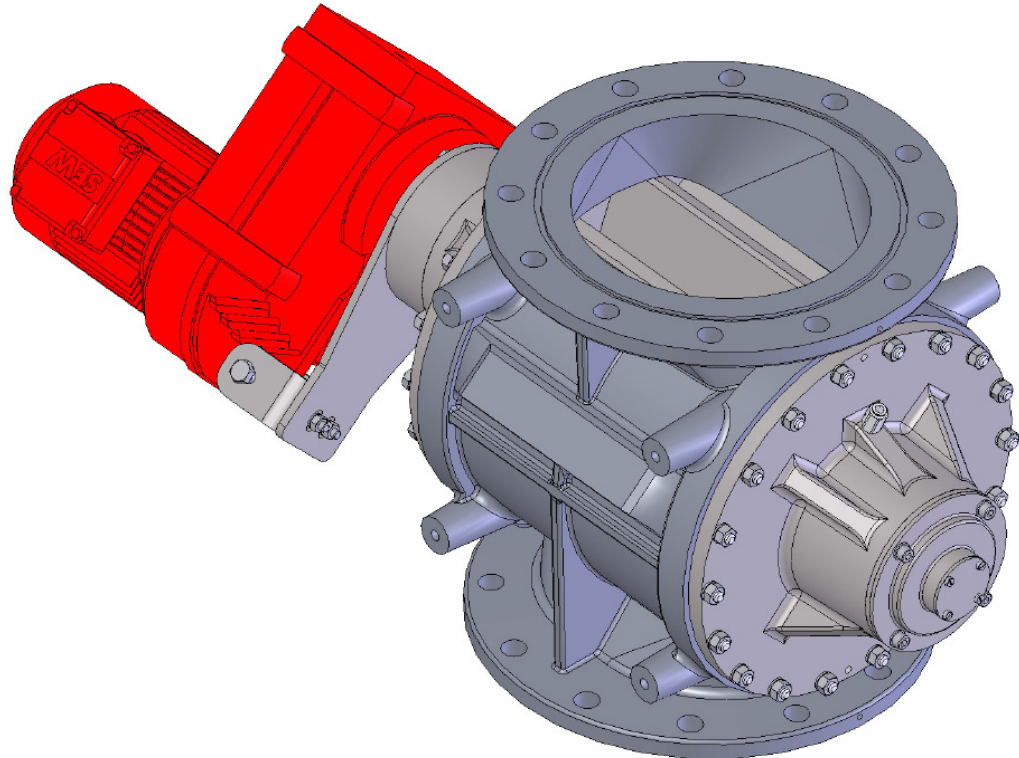

**Rotary feeder for discharging and dosing, as protective system
acc. ATEX for products with dust explosion risk**



Advantages:

**Pressure shock resistant 13 bar g and flame propagation proof,
Protective system category 1 acc. ATEX-directive 94/9/EC,
Dust explosion category St2, zone 20 interior, dust explosion risk
permanent, long-term, oftentimes, zone 21 exterior,
with type examination test by notified body**

Identification:  | 1/2 D

S.S.T.-Schüttguttechnik Maschinenbau GmbH
Lechwiesenstr. 21, 86899 Landsberg / Lech
Tel. 0049 (0)8191-3359-50 / Fax 0049 (0)8191-3359-55
Mail SST@solids-service.de www.solids.de



solids Rotary Valve

Type SRVP-Protective System

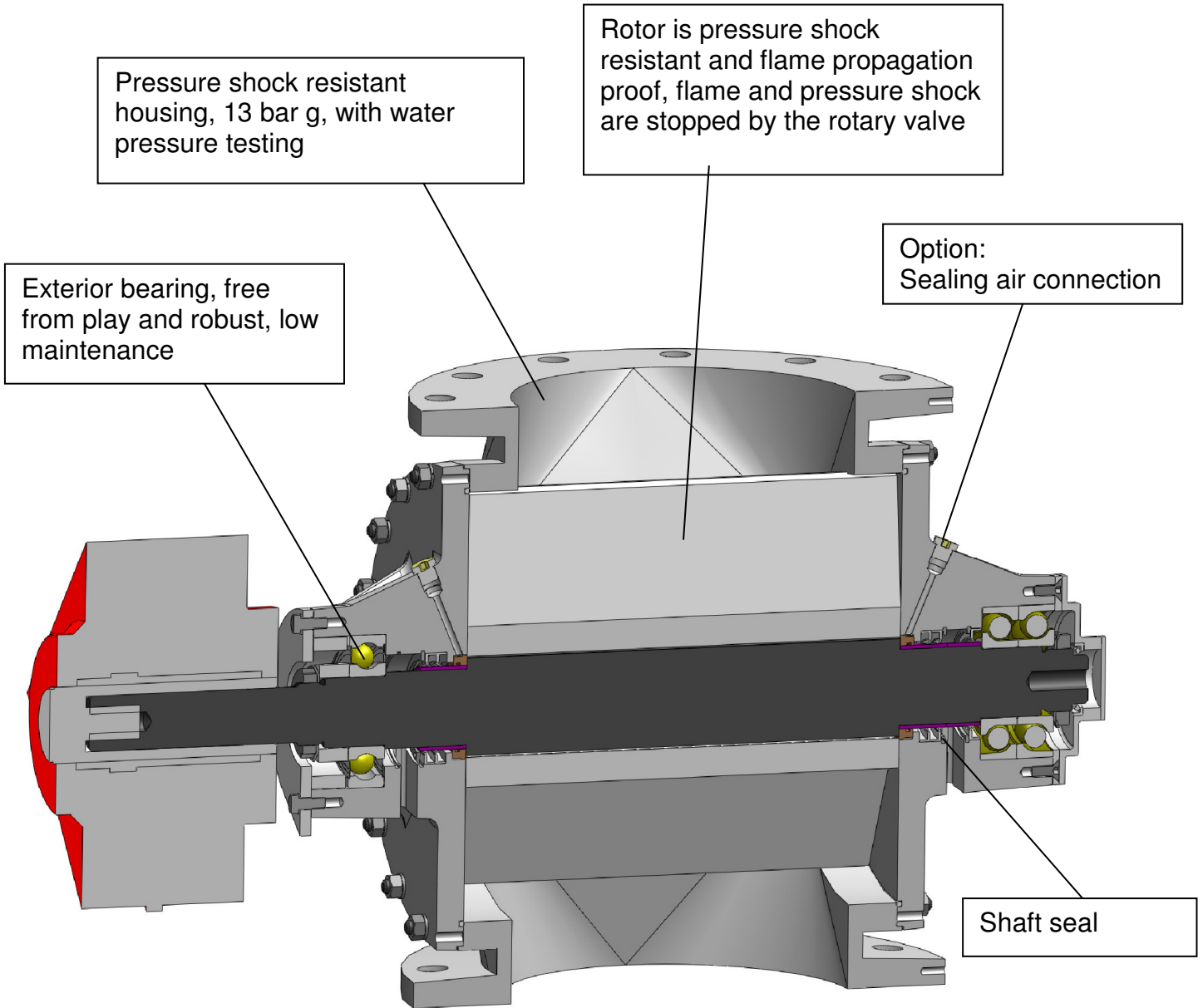

Type	Ø In-/Outlet mm	Height mm	Flow rate ca. l/rotation	Material housing	Material rotor
SRVP150	150	320	3,5	Iron casting Special steel casting	Mild steel
SRVP200	200	375	7		Stainless steel
SRVP250	250	430	15		

S.S.T.-Schüttguttechnik Maschinenbau GmbH
 Lechwiesenstr. 21, 86899 Landsberg / Lech
 Tel. 0049 (0)8191-3359-50 / Fax 0049 (0)8191-3359-55
 Mail SST@solids-service.de www.solids.de

